



St Marys Crescent

£1,195,000

Exceptional 5-Bedroom Home Moments from Sunnyhill Park. Cosway Estates is delighted to offer this beautifully refurbished five-bedroom, two-bathroom family home, ideally situated just steps from the open green spaces of Sunnyhill Park. Finished to an exceptional standard throughout, this impressive property combines modern luxury with spacious, flexible living.

The ground floor features a welcoming entrance hall, a large study, guest W/C, and a bright open-plan living space with a high-spec kitchen and dining area—perfect for entertaining and family life.

On the first floor, you'll find four generous double bedrooms, including one currently used as a dressing room, along with a sleek family bathroom. The top floor is dedicated to a luxurious principal suite with its own bathroom and dressing area.

To the rear, enjoy a sunny garden terrace and a fully powered outhouse with plumbing, ideal as a guest suite, home office, or nanny accommodation or a rental which can achieve around £1,000 per month. Further benefits include SONOS sound system throughout, underfloor heating and off street parking for at least 2 cars. Viewings Highly Advised SOLE AGENTS. CHAIN FREE

Viewing

Please contact our Mill Hill Office on 02089590011 if you wish to arrange a viewing appointment for this property or require further information.



5



2



2



Floor Plan

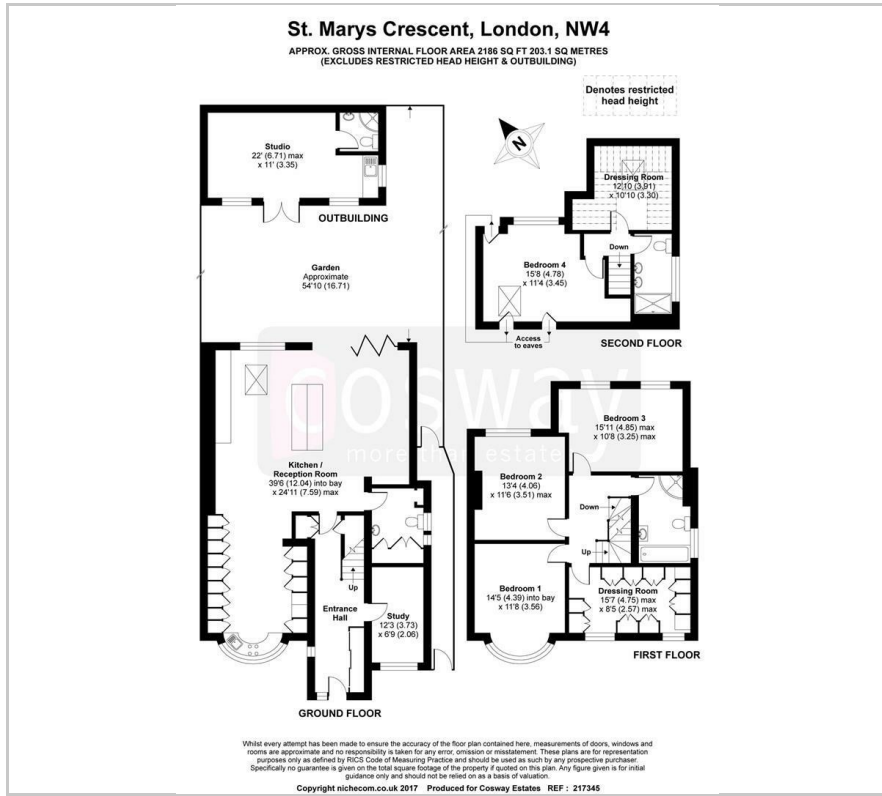

Area Map

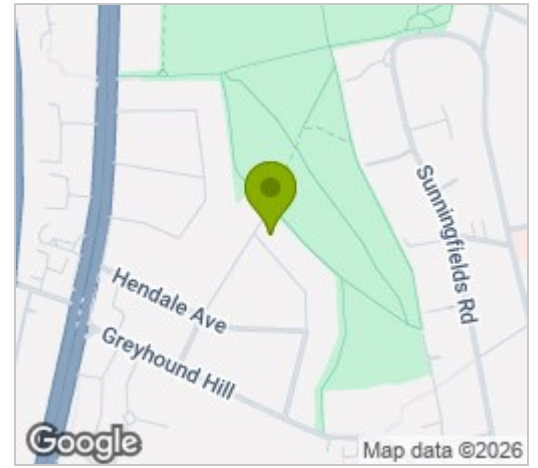

Energy Efficiency Graph

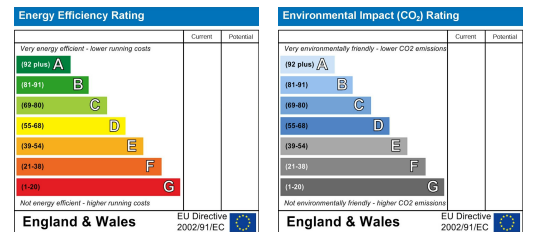

These particulars, whilst believed to be accurate are set out as a general outline only for guidance and do not constitute any part of an offer or contract. Intending purchasers should not rely on them as statements of representation of fact, but must satisfy themselves by inspection or otherwise as to their accuracy. No person in this firm's employment has the authority to make or give any representation or warranty in respect of the property.